

Series 400 Soft Seal Shelter

Chalfant Series 400 Soft Seal Shelter provides a effective seal between your building and truck at your loading dock. Designed with the common variety of trucks in mind.

Standard Construction Features Summary

- The Series 400 Soft Seal Shelter provides tight seal against truck and prevent weather, dust, bugs, exhaust fumes from entering building.
- High resilient premium grade polyurthane foam, bonded with high quality liquid adhesive to kiln dried wood, all are encased inside the dock seal fabric cover to protect it from abuse and the elements (optional 14 gauge galvanized steel backing also available).
- All pads are equipped with air vents to help minimize rupture, and drain holes equipped with brass grommet type drain holes to reduce moisture build-up.
- Raked head frame with curtain that services a wide variety of trucks with a standard curtain height of 36".
- Wide variety of tested high quality fabrics available.
- One (1) year Guarantee against manufacturing defects in material & workmanship from date of installation. *(see warranty)

3-in-1 Guardian Dor-Seal System Options

- Foam backing - Conforms to building wall irregularities.
- Extra wood substructure - Strong, secure connections for installations.

General Options

- Flame-retardent fabric
- Door numbers on unit (specify in notes)
- Reinforce inside side pad wear face; 48" high 96" high
- Bottom draft flaps: 3" 6" Inside Front All
- Metal hood length: 10' 12'; Proj.: 14" 18" 24" 36"
- Full "Z" pattern top of side curtain 3-Ply-reinforcement bottom



Shown with optional full length guide stripe and door number

The Series 400 Soft Seal Shelter features a unique design that acts like a shelter and dock seal combined. The Series 400 Soft Seal Shelter provides foam side pads and dock shelter style curtain, that allows full access to the rear of the trailer and yields under off-center trucks impact, due to improper positioning at the loading dock.



Chalfant has pioneered, developed and provided the industry with quality loading dock equipment since 1940. Safe, affordable, reliable dock equipment, to meet your application needs.

Select Base Fabric And Unit Color

- | | | | | | | |
|--------------------------------------|--------------------------------------|--|--|---|---|--|
| <input type="checkbox"/> 22 oz Vinyl | <input type="checkbox"/> 40 oz Vinyl | <input type="checkbox"/> 16 oz Hypalon | <input type="checkbox"/> 40 oz Hypalon | <input type="checkbox"/> 16 oz Neoprene | <input type="checkbox"/> 40 oz Neoprene | <input type="checkbox"/> High-Tear Resistant Guardian 60 |
| <input type="checkbox"/> Black | <input type="checkbox"/> Black | <input type="checkbox"/> Black | <input type="checkbox"/> Black | <input type="checkbox"/> Black | <input type="checkbox"/> Black | <input type="checkbox"/> Black |
| <input type="checkbox"/> Blue | <input type="checkbox"/> Blue | <input type="checkbox"/> Blue | <input type="checkbox"/> Blue | <input type="checkbox"/> Tan | <input type="checkbox"/> Tan | <input type="checkbox"/> Black |
| <input type="checkbox"/> Tan | <input type="checkbox"/> Tan | <input type="checkbox"/> Green | <input type="checkbox"/> Brown | | | |
| <input type="checkbox"/> Green | <input type="checkbox"/> Brown | <input type="checkbox"/> Brown | | | | |
| <input type="checkbox"/> Brown | | | | | | |

Note: Samples of materials are available upon request, consult Chalfant for other available colors.

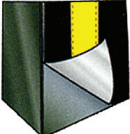
Select Optional Contact Face

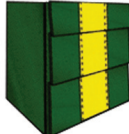
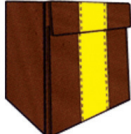
- | | | | | |
|---|---|---|--|---|
| <input type="checkbox"/> Wear Face | <input type="checkbox"/> Guardian Face | <input type="checkbox"/> Guardian Pleat GP4 | <input type="checkbox"/> Guardian Pleat GP8 | <input type="checkbox"/> Guardian Pleat GP 16 |
|  |  |  |  |  |
| | | For Heavy Use.
Exposure: 4"
Overlap: 5"
Total Length: 9" | For Medium Use.
Exposure: 8"
Overlap: 10"
Total Length: 18" | For Medium Use.
Exposure: 16.5"
Overlap: 1.5"
Total Length: 18" |

Select Contact Fabric

- 22 oz Vinyl
- 40 oz Vinyl
- 16 oz Hypalon
- 40 oz Hypalon
- 16 oz Neoprene
- 40 oz Neoprene
- High-Tear Resistant Guardian 60

Consistent with our policy of continuing product improvement, we reserve the right to change these specifications without notice or obligation.

Series 400 Soft Seal Shelter

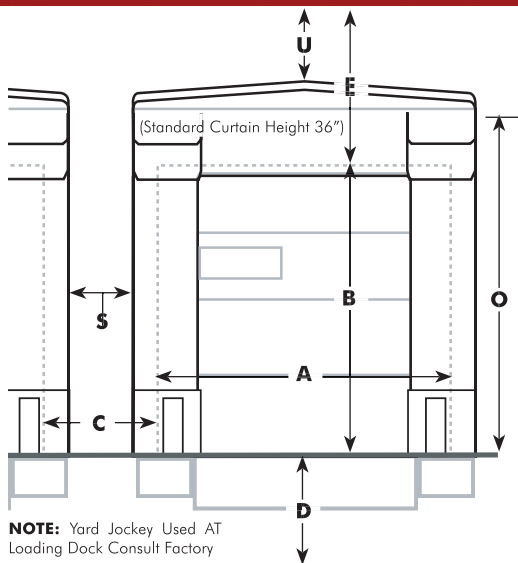

NOTE: Yard Jockey Used AT Loading Dock Consult Factory

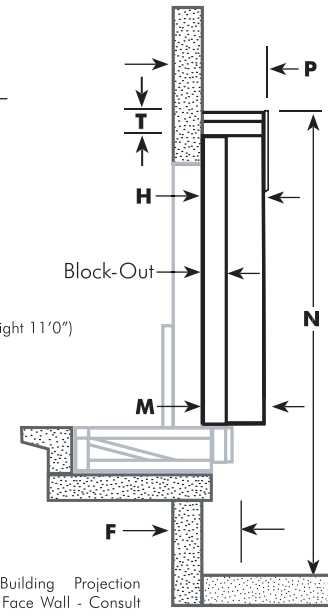
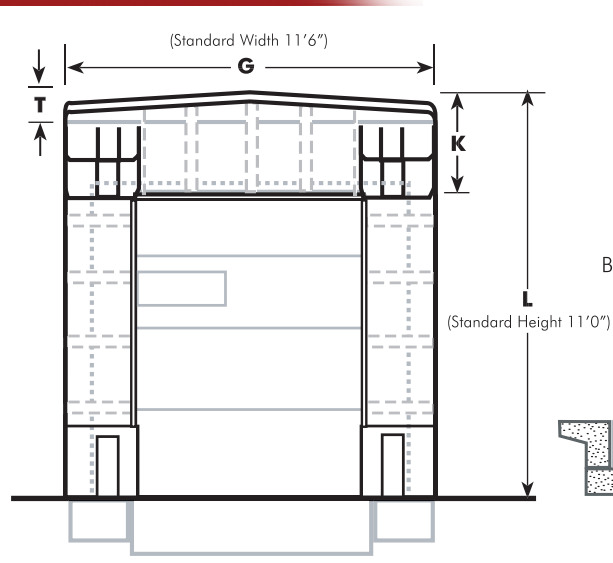

NOTE: Building Projection Past Dock Face Wall - Consult Factory

General Information

Model _____ Color _____
 Door Size: Width-**A** _____ Height-**B** _____
 Number Of Units _____ Base Fabric _____
 Contact Material _____ Contact Face Type _____
 Inside Wear Face _____ Flame-Retardent Fabric
 Full "Z" Pattern Top Of Side Curtain 3-Ply Reinforcement Bottom
 Guide Stripe: Yellow Orange Full Length Standard Length
 Dock Height-**D** _____ Dock Bumper Projection _____
 Plus Wall Set Back _____ Total-**F** _____
 Approach: Level Drive Approach % of Decline _____
 % of Incline _____
 Distance: Between Doors-**C** _____ Between Units-**S** _____
 Clearance : Above Doors-**E** _____ Above Unit-**U** _____

Standard Seal Information

Side Member Length-**O** _____ Block-Out Projection- _____
 Bottom Projection of Unit-**M** _____ Top Projection of Unit-**H** _____
 Head Frame Style-**T** _____ Raked Flat Side Curtain Width _____
 Head Frame Projection-**P** _____ Block-Out Projection- _____
 Front of Seal Opening: Width _____ Height _____
 Overall Outside Unit Dimensions Width-**G** _____ Height-**H** _____
 Total Height of Unit From Driveway-**N** _____
Head Curtain Height-K _____
 Velcro Adjustable Drop Curtain With Pull Ropes
 Foam Front Specify _____ Weighted Door Numbers _____

Truck Service Range

Min. Height _____ Max. Height _____
 Min. Width _____ Max. Width _____

SPECIFY MOUNTING

Type B: Soft-Shelter, Off-Set Moun

CURTAIN - Width of Curtain _____

OPEN DOCK POSITION
400 Series Side Pad

TRUCK IN POSITION
400 Series Curtain In Compression

Customer: _____
 Signature Approval By: _____
 Project: _____
 Address: _____
 City: _____ State: _____
 Architect/GC: _____

Authorized Dealer